

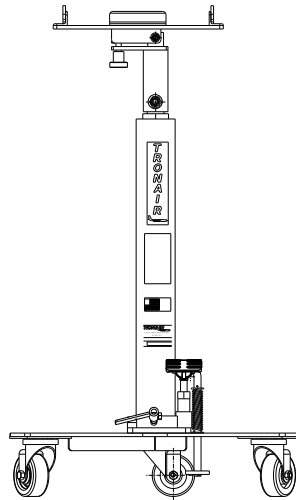

OPERATION & SERVICE MANUAL



Models: 04-6027-0110
J-Pats Battery Lift
Includes Illustrated Parts List

05/2012 – Rev. 04

REVISION

03

04

DATE

07/2009

05/2012

TEXT AFFECTED

Modified 2.0 Specifications

Modified 2.0 Specifications, 3.0 Assembly Instructions and Parts List

TABLE OF CONTENTS

	<u>PAGE</u>
1.0 GENERAL DESCRIPTION	1
2.0 SPECIFICATIONS	1
3.0 ASSEMBLY INSTRUCTIONS.....	1
4.0 OPERATING INSTRUCTIONS	1
4.1 TO RAISE BATTERY	1
4.2 TO LOWER BATTERY	1
4.3 FILLING THE RESERVOIR	1
5.0 PROVISION OF SPARES.....	1
5.1 SOURCE OF SPARE PARTS.....	1
5.2 RECOMMENDED SPARE PARTS LISTS	1
6.0 GUARANTEES/LIMITATION OF LIABILITY	2

This product can not be modified without the written approval of Tronair, Inc. Any modifications done without written approval voids all warranties and releases Tronair, Inc., its suppliers, distributors, employees, or financial institutions from any liability from consequences that may occur. Only Tronair OEM replacement parts shall be used.

1.0 GENERAL DESCRIPTION

This Tronair Battery Lift, Model 04-6027-0110, is designed to aid in the installation and removal of batteries in the J-Pat aircraft.

2.0 SPECIFICATIONS

- Maximum Capacity: 100 lbs (Vertical Lift)
- Collapsed Height: 33 ⁷/₁₆ inches
- Extended Height: 52 ¹⁵/₁₆ inches
- Net Weight: 45 lbs

3.0 ASSEMBLY INSTRUCTIONS

1. Attach pump/cylinder assembly (Item 9) and casters (Items 11, 12, 13, 15) to base weldment (Item 14) using the four ¼" bolts, stopnuts and washers (Items 11, 12, 13) supplied. Torque bolts to 75 ft-lbs.
2. Insert foot pedal assembly through hole in front of pump. Slide one ½" washer (Item 23) and compression spring (Item 25) over foot pedal assembly (Item 24), one washer at each end of the spring. Compress the spring past the hole in the foot pedal assembly and put a cotter pin (Item 16) in the hole. Slide a ½" washer (Item 23) over foot pedal shaft and insert the foot pedal into the hole in the pump handle end. Slide ½" washer (Item 23) over foot pedal shaft and put cotter pin (Item 16) in hole pedal assembly.
3. Attach table assembly to the ram (Item 28, 29, 30).
4. Ensure all bolts, stopnuts, and cotter pins are securely fastened before operating.
5. Ensure foot pedal assembly operates freely without binding.

4.0 OPERATING INSTRUCTIONS

CAUTION!



- Do not transport batteries on this battery lift.
- Operator injury and/or battery damage can result.
- This battery lift is designed to only lift or lower batteries at aircraft.

4.1 TO RAISE BATTERY

1. Place battery lift on hard level surface.
2. Close release valve by rotating foot release lever assembly (Item 10) clockwise.
3. Pump foot pedal assembly (Item 24) until desired height is reached.
4. If binding occurs, lubricate linkage.

4.2 TO LOWER BATTERY

Slowly open release valve by rotating foot release lever assembly (Item 10) counter-clockwise.



CAUTION!

Battery damage and/or operator injury could result if release valve is opened too quickly

4.3 FILLING THE RESERVOIR

1. Remove reservoir plug.
2. Open release valve.
3. Fill reservoir with hydraulic oil.
4. Stand unit on its base and let excess oil run out. Replace reservoir plug.
5. Pump operating handle rapidly with release valve open to exhaust any air in system.
6. Close release valve and pump operating handle.
7. Repeat above instructions if plunger fails to advance.

5.0 PROVISION OF SPARES

5.1 SOURCE OF SPARE PARTS

Spare parts may be obtained from the manufacturer:

TRONAIR, Inc.
1 Air Cargo Pkwy East
Swanton, Ohio 43558 USA

Telephone: (419) 866-6301 or 800-426-6301
Fax: (419) 867-0634
E-mail: sales@tronair.com
Website: www.tronair.com

5.2 RECOMMENDED SPARE PARTS LISTS

Reference the following page(s) for Replacement Parts and Kits available.

6.0 GUARANTEES/LIMITATION OF LIABILITY

Tronair products are warranted to be free of manufacturing or material defects for a period of one year after shipment to the original customer. This is solely limited to the repair or replacement of defective components. This warranty does not cover the following items:

- a) Parts required for normal maintenance
- b) Parts covered by a component manufacturers warranty
- c) Replacement parts have a 90-day warranty from date of shipment

If you have a problem that may require service, contact Tronair immediately. Do not attempt to repair or disassemble a product without first contacting Tronair, any action may affect warranty coverage. When you contact Tronair be prepared to provide the following information:

- a) Product Model Number
- b) Product Serial Number
- c) Description of the problem

If warranty coverage is approved, either replacement parts will be sent or the product will have to be returned to Tronair for repairs. If the product is to be returned, a Return Material Authorization (RMA) number will be issued for reference purposes on any shipping documents. Failure to obtain a RMA in advance of returning an item will result in a service fee. A decision on the extent of warranty coverage on returned products is reserved pending inspection at Tronair. Any shipments to Tronair must be shipped freight prepaid. Freight costs on shipments to customers will be paid by Tronair on any warranty claims only. Any unauthorized modification of the Tronair products or use of the Tronair products in violation of cautions and warnings in any manual (including updates) or safety bulletins published or delivered by Tronair will immediately void any warranty, express or implied.

The obligations of Tronair expressly stated herein are in lieu of all other warranties or conditions expressed or implied. **Any unauthorized modification of the Tronair products or use of the Tronair products in violations of cautions and warnings in any manual (including updates) or safety bulletins published or delivered by Tronair will immediately void any warranty, express or implied and Tronair disclaims any and all liability for injury (WITHOUT LIMITATION and including DEATH), loss or damage arising from or relating to such misuse.**

Parts List

When ordering replacement parts/kits, please specify model, serial number and color of your unit.

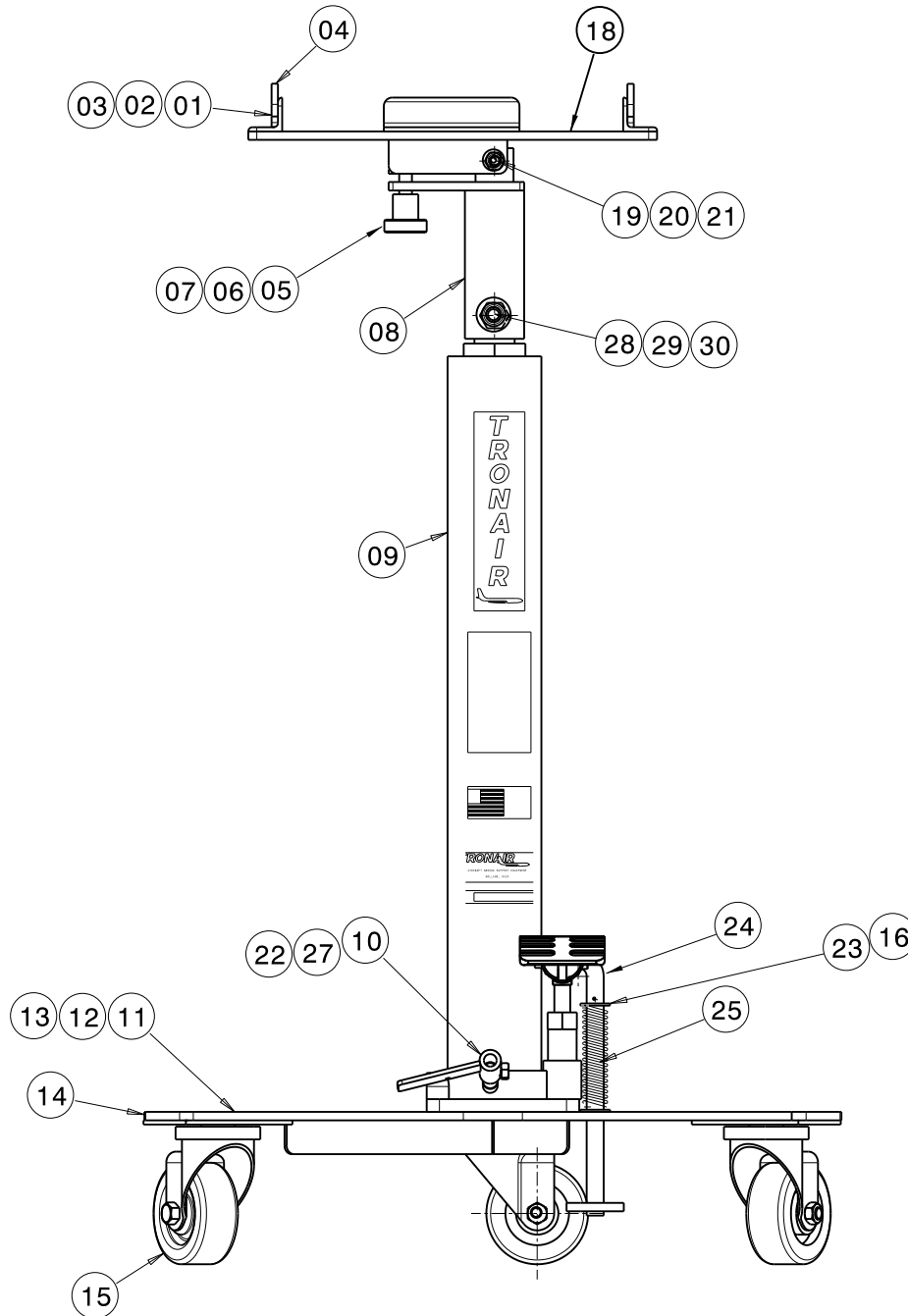

Parts List

When ordering replacement parts/kits, please specify model, serial number and color of your unit.

Item	Part Number	Description	Qty
5	Z-3677	Weldment, Knob	1
6	G-1250-1050N	Flatwasher, ¼ Narrow	1
7	G-1202-1050	Stopnut, ¼-20 Elastic	1
8	Z-7853	Weldment, End Mount	1
9	Z-7845	Assembly, Hydraulic Jack	1
10	Z-1159	Weldment, Release Lever	1
14	Z-7843-01	Weldment, Base	1
16	G-1301-01	Pin, Cotter 3/16" diameter x 1.0" long	3
18	Z-3679-01	Weldment, Table	1
19	G-1155-106220	Screw, Hex Socket Shoulder, 3/8" diameter x 2" long	1
20	G-1250-1060N	Flatwasher, 5/16 Narrow	1
21	G-1202-1060	Stopnut, 5/16 -18 Elastic	1
22	G-1163-01	Cup Point, Hex Socket Head, ¼-28 x 3/8" long	2
23	G-1255-09	Washer, ½ AN	4
24	Z-7915	Assembly, Spring Stop	1
25	H-3512-01	Spring	1
27	R-2668	Valve, Release Screw	1
28	G-1100-109526	Bolt, HH Grade 5, ½ - 20 2 ¾ Long	1
29	G-1250-1090	Flatwasher, ½ Narrow	2
30	G-1205-1095	ESN, ½ - 20	1
	K-3030	Kit, Caster Replacement; consists of:	
11	G-1100-105510	Bolt, Hex Head, Grade 5, ¼-28 x 1" long	4
12	G-1255-05	Washer, ¼ AN	4
13	G-1202-1055	Stopnut, ¼-28 Elastic	4
15	U-1000	Caster	1
	K-3031	Kit, Latch Replacement; consists of:	
1	G-1156-103506	Screw, Flat Head Cross Recess, #10-32 x 1" long	1
2	G-1250-1030N	Flatwasher, #10 Narrow	1
3	G-1202-1035	Stopnut, #10-32 Elastic	1
4	J-2645	Plate, Latch	1