

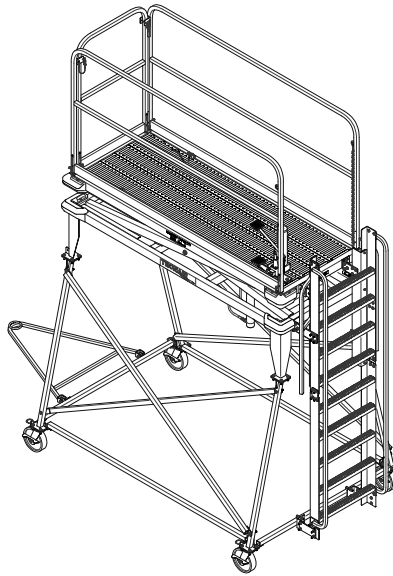

Operation & Service Manual



Models: 04-6030-9111
B5 Type Maintenance Platform

05/2003 – AA – Rev. OR

Includes Illustrated Parts Lists

Tronair, Inc.

*1740 Eber Road
Holland, Ohio 43528-9794
USA*

Telephone: (419) 866-6301 • 800-426-6301

Fax: (419) 867-0634

Web Site: www.tronair.com E-mail: mail@tronair.com

Model: 04-6030-9111
B5 Type Maintenance Platform

TABLE OF CONTENTS

PAGE

| | | |
|-----|------------------------------|---|
| 1.0 | Specifications..... | 1 |
| 1.1 | Features..... | 1 |
| 2.0 | Assembly Instructions | 1 |
| 3.0 | Operation Instructions | 3 |
| 4.0 | Parts List..... | 3 |

Model: 04-6030-9111
B5 Type Maintenance Platform

1.0 SPECIFICATIONS

| | |
|--------------------------|-------------|
| Capacity: | 500 lbs |
| Work Platform Area: | 3 ft x 8 ft |
| Lowered Platform Height: | 8.5 ft |
| Raised Platform Height: | 12 ft |

1.1 FEATURES

- Mechanical Platform Stops
- Removable Side Rails
- Hydraulic Foot Pedal
- Locking Swivel Casters
- Towbar
- Optional Pneumatic Foot Pedal

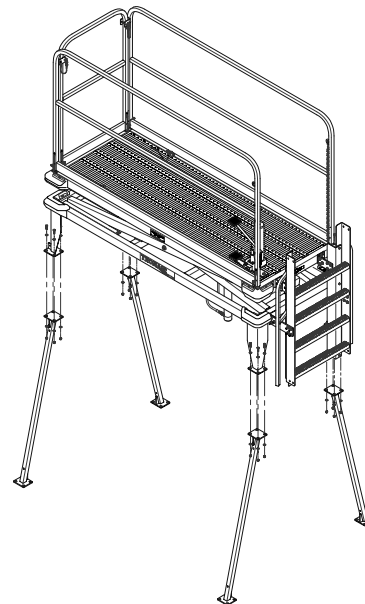

FIGURE 1

2.0 ASSEMBLY INSTRUCTIONS

1. Raise work platform assembly approximately 90 inches off the floor.
2. Install platform extensions to the bottom of platform assembly using $\frac{3}{8}$ -16 x 1½ inch long bolts (See *Figure 1*). **Note: Do not tighten bolts.**
3. Install extension braces, casters and swivel locks using $\frac{3}{8}$ -16 x 1½ inch long bolts. (See *Figure 2*)

NOTE: DO NOT TIGHTEN BOLTS.

4. Install cross braces using $\frac{3}{8}$ -16 x 3 inch long bolts (See *Figure 3* – Page 2).
5. Tighten all bolts; torque to 25 in-lbs.
6. Install the ladder extension using the splice plates and $\frac{3}{8}$ -16 x 1½ inch long bolts. Assemble the extension handle using $\frac{3}{8}$ -16 x 1½ inch long bolts and secure the ladder to the extension brace using the U-bolt, angle and $\frac{3}{8}$ -16 x 1½-inch long bolts. (See *Figure 4* – Page 2).
7. Install the towbar using $\frac{3}{8}$ inch diameter shoulder bolts (See *Figure 5* - Page 2).

2.0 Assembly Instructions continued on following page.

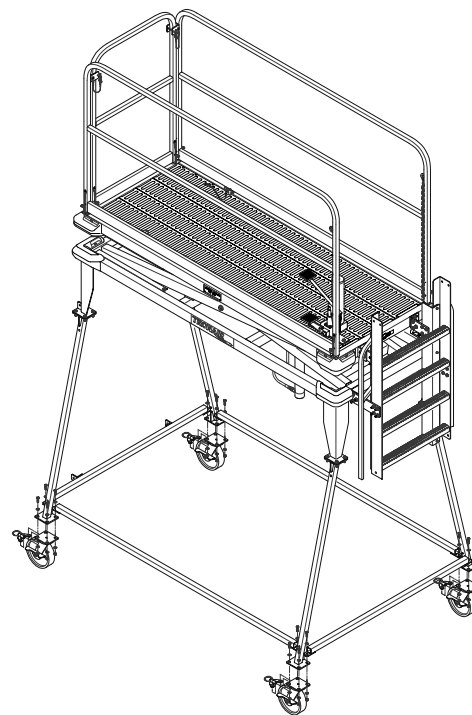

FIGURE 2

Model: 04-6030-9111
B5 Type Maintenance Platform

2.0 ASSEMBLY INSTRUCTIONS

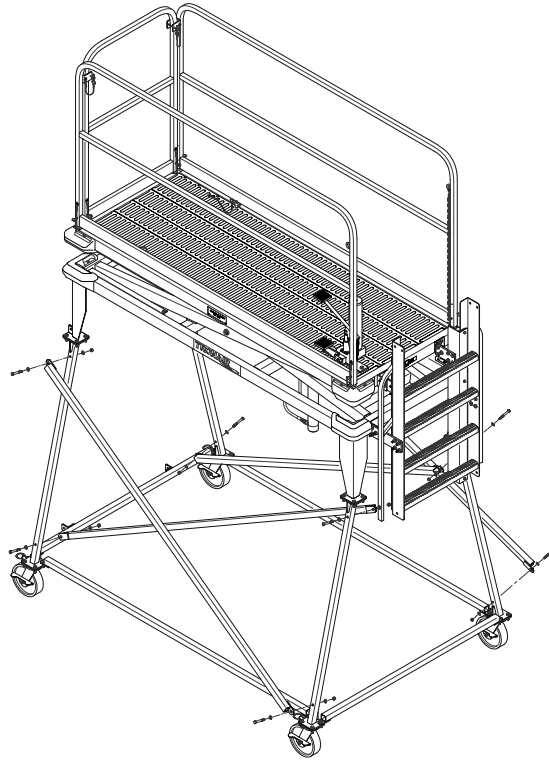

FIGURE 3

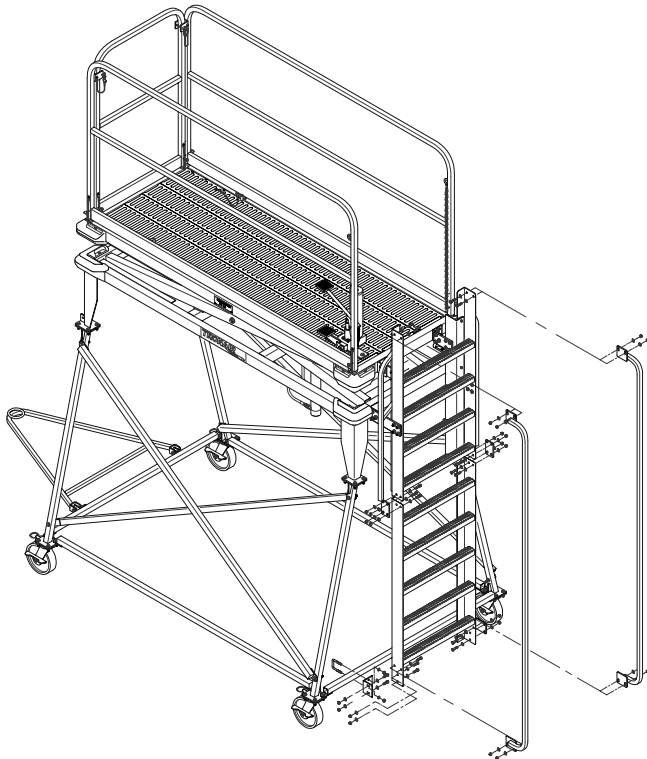

FIGURE 4

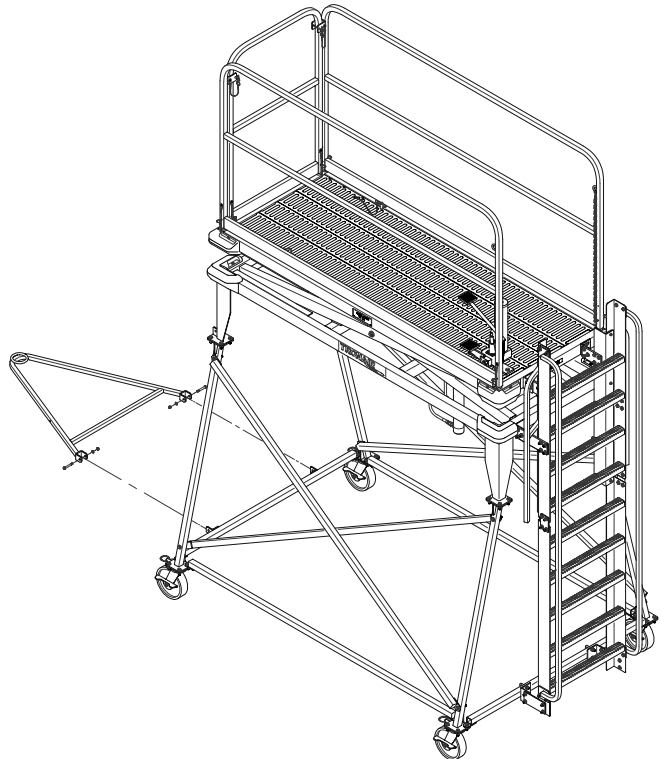

FIGURE 5

TRONAIR

05/2003 - AA - Rev OR

Model: 04-6030-9111
B5 Type Maintenance Platform

3.0 OPERATION INSTRUCTIONS

1. Check reservoir level; fill as required with MIL-H-5606 hydraulic oil.
2. Ensure mechanical stop pins are not in the stop holes before raising the platform.
3. Raise the platform by pumping the foot pump until the desired height has been reached.
4. Install the mechanical stops. If the hole is blocked, install pins into next hole down.
5. While working on the platform, it is recommended that the safety chain and the railings remain in place.
6. When the platform is in use, it should always be locked in place with the mechanical stop pins.

NOTE: NEVER use the ladder while the platform is raising or lowering.

7. The platform is lowered by first raising it off the mechanical stop pins.
8. Remove the mechanical stop pins.
9. Actuate the relief foot valve on the pump to lower the platform.

Notes: 1. ALWAYS ensure the ladder and scissors area are clear of obstacles and/or Personnel before lowering.

2. NEVER tow the platform with anyone on it.

4.0 PARTS LIST

Reference Pages 4 – 7 for ordering information of Replacement Parts and Kits.

When ordering Replacement Parts/Kits, please specify Model & Serial Number, as well as the **color** of your product.

Model: 04-6030-9111
B5 Type Maintenance Platform

Parts List

** When ordering replacement parts/kits, please specify Model, Color & Serial Number of your unit.**

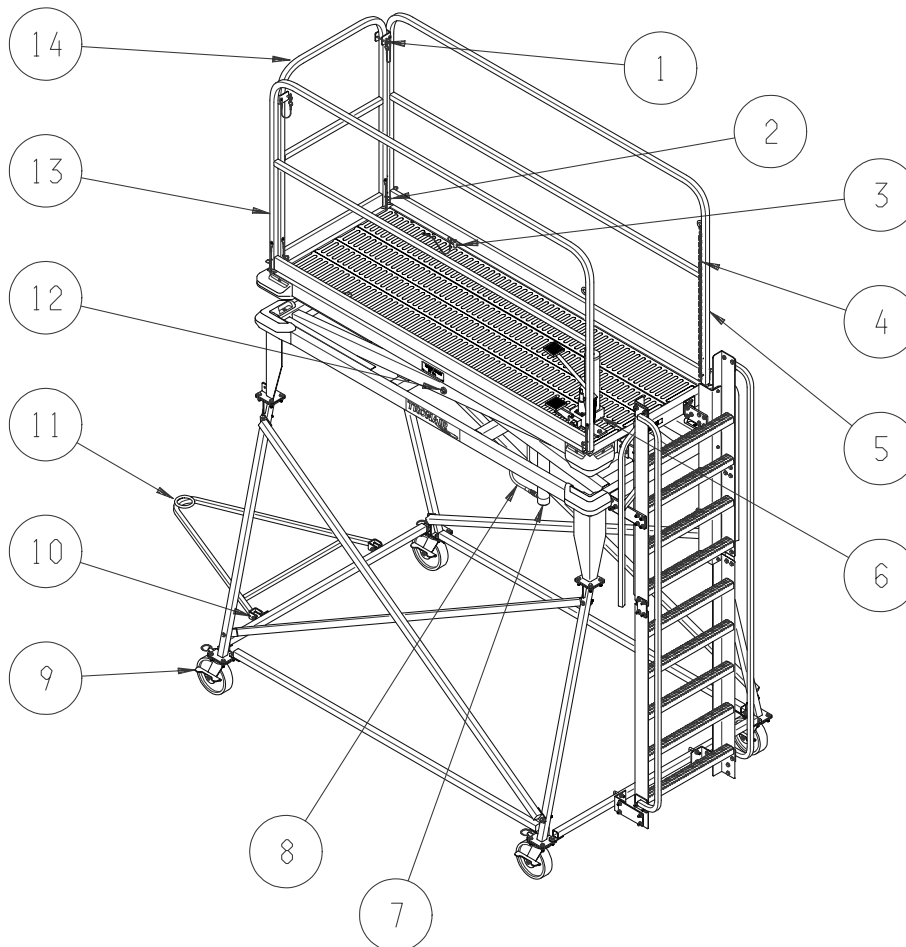

| ITEM | PART NUMBER | DESCRIPTION | QTY |
|------|----------------|--|-----|
| 5 | Z-4406 | Assembly, (Right) Side Rail (includes Items 1 & 4) | 1 |
| 6 | HC-1888-02 | Pump, Hydraulic Foot | 1 |
| 8 | TF-1043-03*120 | Assembly, Hose | 1 |
| 11 | Z-4771 | Assembly, (Left) Side Rail (includes Item 1) | 1 |
| 13 | Z-4404 | Assembly, B4 Stand Towbar | 1 |
| 14 | Z-4402 | Assembly, End Rail (includes Item 2, Qty. 2) | 1 |
| | K-2752 | Kit, Ball Lok-T Replacement; consists of: | |
| 1 | G-1310-0420 | Pin, Ball Lok-T, 1/4" diameter x 2" long | 1 |
| | G-1351-04 | Rivet | 1 |
| | H-1026*07.0 | Assembly, Lanyard | 1 |

continued on following page.



Model: 04-6030-9111
B5 Type Maintenance Platform

Parts List

** When ordering replacement parts/kits, please specify Model, Color & Serial Number of your unit.**

| ITEM | PART NUMBER | DESCRIPTION | QTY |
|---------|----------------------|--|-----|
| | K-3089 | Kit, Aerofast Pin Replacement; consists of: | |
| 2..... | G-1307-0418 | Pin, Aerofast Pin, ¼" diameter x 1.8" long..... | 1 |
| | G-1351-04 | Rivet..... | 1 |
| | H-1026*07.0..... | Assembly, Lanyard..... | 1 |
| | K-2700 | Kit, Ball Lok-T Replacement; consists of: | |
| 3..... | G-1310-0855 | Pin, Ball Lok-T, ½" diameter x 5 ½" long..... | 1 |
| | G-1351-04 | Rivet..... | 1 |
| | H-1026*12.0..... | Assembly, Lanyard | 1 |
| | K-3090 | Kit, Safety Chain Replacement; consists of: | |
| 4..... | H-1024-01*34.0 | Chain, Double Loop 2/0 | 1 |
| | H-1518-03 | S-Hook..... | 2 |
| | K-3450 | Kit, Cylinder Replacement; consists of: | |
| 7..... | HC-2034-01..... | Cylinder, Hydraulic (Mineral Base) | 1 |
| | G-1151-107214 | Screw, Socket Head Cap, ¾ -24 x 1 ½" long | 4 |
| | G-1155-110220 | Screw, Hex Socket Head Shoulder | 1 |
| | | ¾" diameter, ⅝ -11 x 2" long | |
| | G-1202-1100 | Stopnut, ⅝ -11 Elastic | 1 |
| | K-3289 | Kit, Caster Replacement; consists of: | |
| 9..... | U-1085..... | Caster, Swivel | 1 |
| | U-1087..... | Lock, Demountable Swivel | 1 |
| | G-1100-107014 | Bolt, Hex Head, Grade 5, ¾ -16 x 1 ½" long | 4 |
| | G-1202-1070 | Stopnut, ¾ -16 Elastic | 4 |
| | G-1250-1070N | Flatwasher, ¾ Narrow | 8 |
| | K-3290 | Kit, Towbar Pivot Replacement; consists of: | |
| 10..... | G-1155-106220 | Screw, Hex Socket Head Shoulder | 2 |
| | | ¾" diameter x ⅝ -18 x 2" long | |
| | G-1202-1060 | Stopnut, ⅝ -18 Elastic | 2 |
| | G-1250-1060N | Flatwasher, ⅝ Narrow | 2 |
| | K-3124 | Kit, Pivot Pin Replacement; consists of: | |
| 12..... | R-1448..... | Pin, Pivot | 1 |
| | G-1301-01 | Pin, Cotter..... | 2 |



Parts List

**** When ordering replacement parts/kits, please specify Model, Color & Serial Number of your unit.****

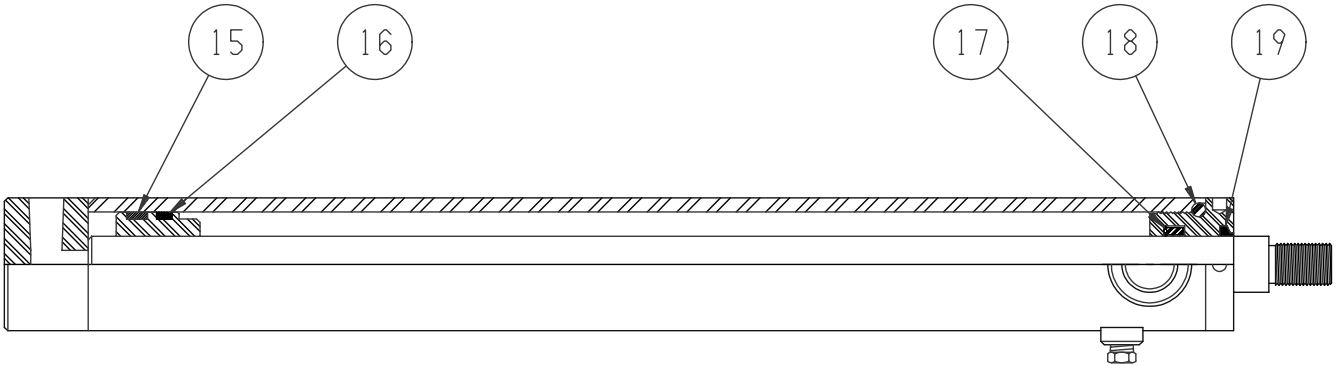

| ITEM | PART NUMBER | DESCRIPTION | QTY |
|---------|---------------|--|-----|
| | K-3291 | Kit, Cylinder Seals Replacement; consists of: | |
| 15..... | | Ring, Seal..... | 1 |
| 16..... | | Seal, PSP..... | 1 |
| 17..... | | Polypak..... | 1 |
| 18..... | | O-ring..... | 1 |
| 19..... | | Wiper, Rod..... | 1 |

Pump Seals Parts List

Reference Illustration on the following page

| ITEM | PART NUMBER | DESCRIPTION | QTY |
|---------|---------------|---|-----|
| | K-3444 | Kit, Pump Seal Replacement; consists of: | |
| 20..... | | O-ring, Release Screw..... | 1 |
| 21..... | | O-ring, Outlet..... | 1 |
| 22..... | | O-ring, Outlet Check..... | 1 |
| 23..... | | O-ring, Tube Seal..... | 1 |
| 24..... | | O-ring, Valve Body..... | 1 |
| 25..... | | O-ring, Piston..... | 1 |
| 26..... | | Backup Ring, Piston..... | 1 |
| 27..... | | Wiper, Rod..... | 1 |
| 28..... | | O-ring, Reservoir Mount..... | 1 |
| 29..... | | O-ring, Reservoir Seal..... | 1 |
| 30..... | | Backup Ring, Piston..... | 1 |
| 31..... | | O-ring, Piston..... | 1 |
| 32..... | | O-ring, Piston..... | 1 |
| 33..... | | Backup Ring, Piston..... | 1 |
| 34..... | | O-ring, Seal..... | 1 |

Parts List

**** When ordering replacement parts/kits, please specify Model, Color & Serial Number of your unit.****

