

Model: 08-0137-6000
Fuselage Mounted Hoist

05/2017 – Rev. 01

Includes Illustrated Parts Lists

REVISION
OR
01

DATE
11/1998
05/2017

TEXT AFFECTED
Original release
Major revision

TABLE OF CONTENTS

	<u>PAGE</u>
1.0 PRODUCT INFORMATION	1
1.1 DESCRIPTION.....	1
1.2 MODEL & SERIAL NUMBER.....	1
1.3 MANUFACTURER.....	1
2.0 SAFETY INFORMATION.....	1
2.1 USAGE AND SAFETY INFORMATION.....	1
3.0 TRAINING.....	1
3.1 TRAINING REQUIREMENTS.....	1
3.2 TRAINING PROGRAM.....	1
3.3 OPERATOR TRAINING.....	1
4.0 INSTALLATION INSTRUCTIONS.....	2
5.0 INSPECTION/MAINTENANCE.....	3
6.0 PROVISION OF SPARES.....	4
6.1 SOURCE OF SPARE PARTS.....	4
7.0 IN SERVICE SUPPORT.....	4
8.0 GUARANTEES/LIMITATION OF LIABILITY.....	4

This product can not be modified without the written approval of Tronair, Inc. Any modifications done without written approval voids all warranties and releases Tronair, Inc., its suppliers, distributors, employees, or financial institutions from any liability from consequences that may occur. Only Tronair OEM replacement parts shall be used.

1.0 PRODUCT INFORMATION

1.1 DESCRIPTION

The Tronair Fuselage Mounted Hoist, Model 08-0137-6000 is used for lifting small components in the rear fuselage of the RJ-700 aircraft.

1.2 MODEL & SERIAL NUMBER

Reference nameplate on unit

1.3 MANUFACTURER

TRONAIR, Inc.
1740 Eber Road
Holland, Ohio 43528-9794 USA

Telephone: (419) 866-6301 or 800-426-6301
Fax: (419) 867-0634
E-mail: sales@tronair.com
Website: www.tronair.com

2.0 SAFETY INFORMATION

2.1 USAGE AND SAFETY INFORMATION

To insure safe operations please read the following statements and understand their meaning. Also refer to your equipment manufacturer's manual for other important safety information. This manual contains safety precautions which are explained below. Please read carefully.



WARNING! — Warning is used to indicate the presence of a hazard that **can cause severe personal injury, death, or substantial property damage** if the warning notice is ignored.

CAUTION! — Caution is used to indicate the presence of a hazard that **will or can cause minor personal injury or property damage** if the caution notice is ignored.

3.0 TRAINING

3.1 TRAINING REQUIREMENTS

The employer of the operator is responsible for providing a training program sufficient for the safe operation of the unit.

3.2 TRAINING PROGRAM

The employer provided operator training program should cover safety procedures concerning use of the unit in and around the intended aircraft at the intended aircraft servicing location.

3.3 OPERATOR TRAINING

The operator training should provide the required training for safe operation of the unit.

NOTE: Maintenance and Trouble Shooting are to be performed by a skilled and trained technician.

4.0 INSTALLATION INSTRUCTIONS

1. Hang the beam assembly in the rear fuselage using aft strap and forward/engine strap with the cross beam.

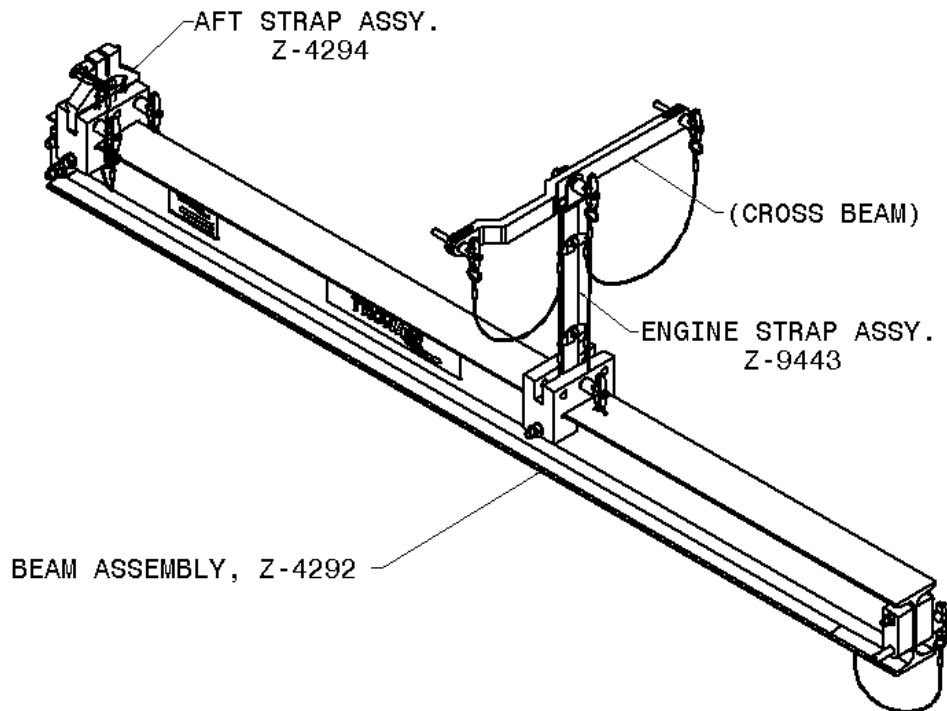

2. After the I beam is hung in place by the mounting straps, assembly the trolley on the I beam by pulling the front stop and rolling the trolley onto the I beam. After the trolley is installed onto the I beam, install the stop pin.

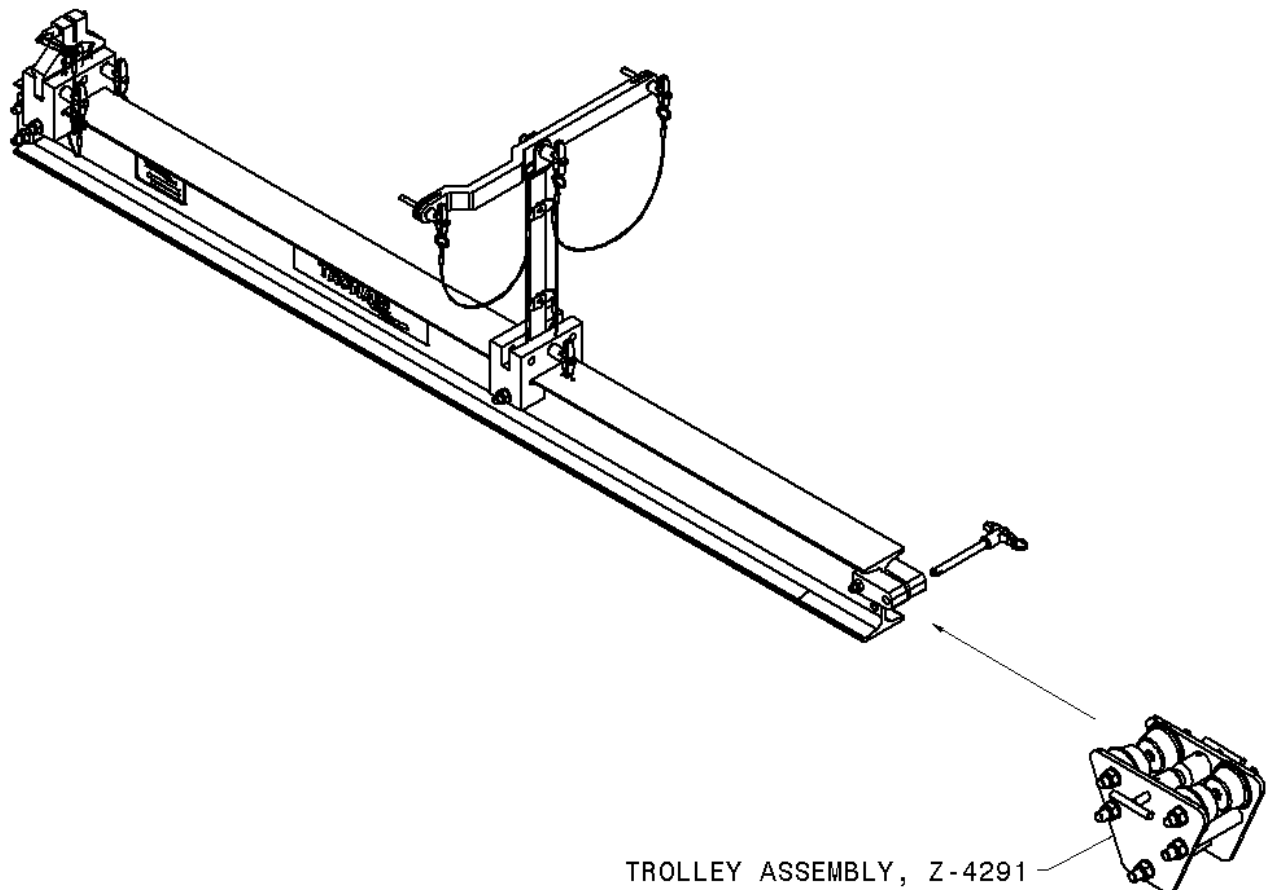

4.0 Installation instructions continued on following page.

4.0 INSTALLATION INSTRUCTIONS *(continued)*

3. Install chain fall to trolley.

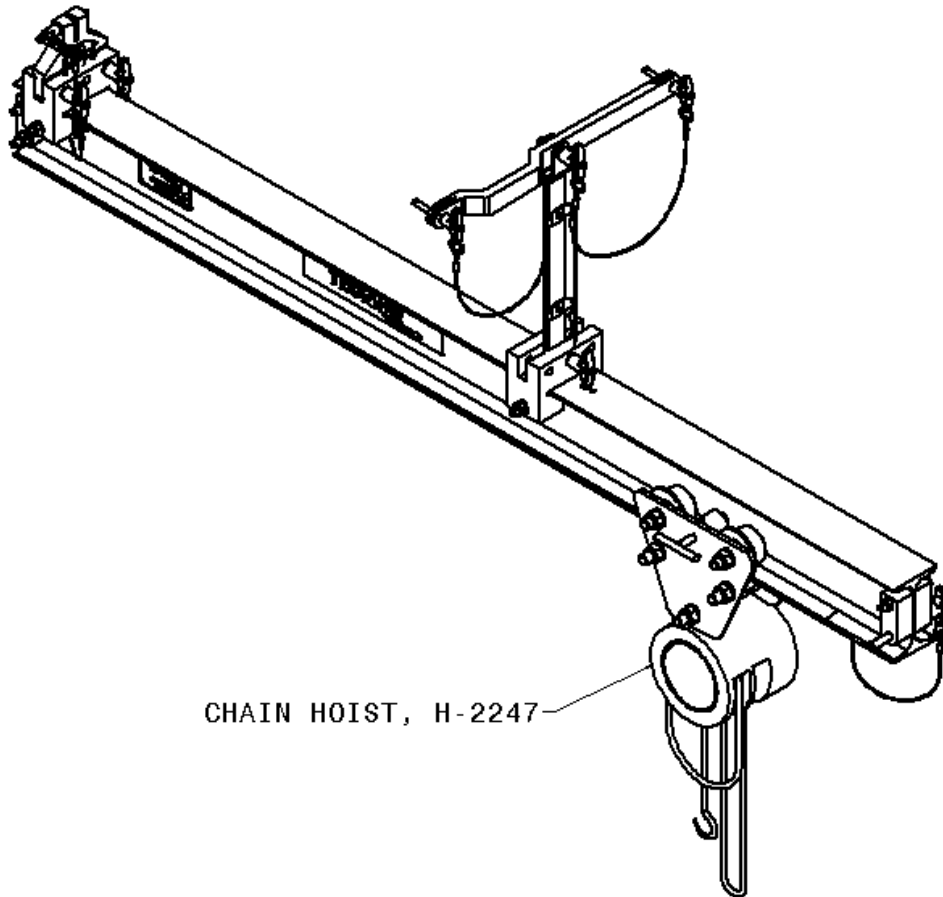

CHAIN HOIST, H-2247

4. The fuselage mounted hoist is now ready for usage.
5. To remove the fuselage hoist, reverse installation instructions.

5.0 INSPECTION/MAINTENANCE

SERVICE	INTERVAL	
Normal	Yearly	Inspect equipment at site of use. Operation with various weights within the rated load limit, or uniform loads less than 65 percent of rated load.
Heavy	Semi-Annual	Inspect equipment at site of use unless external conditions indicate that disassembly should be done to permit detailed inspection. Operation within the rated load limit that exceeds normal service.
Severe	Quarterly	Inspect equipment at site of use unless external conditions indicate that disassembly should be done to permit detailed inspection. Operation at normal or heavy service under abnormal operating conditions.
Special/ Infrequent	As recommended by a qualified person before the first such use and as directed by the qualified person for any subsequent uses	

It is recommended to send Equipment to Manufacturer or Authorized Service Center for Recertification.

Rated load at engine sling lift hole: 250 lbs.

The rated capacity shall not be more than 80 percent of the maximum load sustained during the test. Test loads shall not be more than 125 percent of the rated capacity unless otherwise recommended by the manufacturer. Test weights shall be accurate to within -5 percent, +0 percent of stipulated values.

6.0 PROVISION OF SPARES

6.1 SOURCE OF SPARE PARTS

Spare parts may be obtained from the manufacturer:

TRONAIR, Inc.

1740 Eber Road

Holland, Ohio 43528-9794 USA

Telephone: (419) 866-6301 or 800-426-6301

Fax: (419) 867-0634

E-mail: sales@tronair.com

Website: www.tronair.com

7.0 IN SERVICE SUPPORT

Contact Tronair, Inc. for technical services and information. See Section 1.3 – Manufacturer.

8.0 GUARANTEES/LIMITATION OF LIABILITY

Tronair products are warranted to be free of manufacturing or material defects for a period of one year after shipment to the original customer. This is solely limited to the repair or replacement of defective components. This warranty does not cover the following items:

- a) Parts required for normal maintenance
- b) Parts covered by a component manufacturers warranty
- c) Replacement parts have a 90-day warranty from date of shipment

If you have a problem that may require service, contact Tronair immediately. Do not attempt to repair or disassemble a product without first contacting Tronair, any action may affect warranty coverage. When you contact Tronair be prepared to provide the following information:

- a) Product Model Number
- b) Product Serial Number
- c) Description of the problem

If warranty coverage is approved, either replacement parts will be sent or the product will have to be returned to Tronair for repairs. If the product is to be returned, a Return Material Authorization (RMA) number will be issued for reference purposes on any shipping documents. Failure to obtain a RMA in advance of returning an item will result in a service fee. A decision on the extent of warranty coverage on returned products is reserved pending inspection at Tronair. Any shipments to Tronair must be shipped freight prepaid. Freight costs on shipments to customers will be paid by Tronair on any warranty claims only. Any unauthorized modification of the Tronair products or use of the Tronair products in violation of cautions and warnings in any manual (including updates) or safety bulletins published or delivered by Tronair will immediately void any warranty, express or implied.

The obligations of Tronair expressly stated herein are in lieu of all other warranties or conditions expressed or implied. **Any unauthorized modification of the Tronair products or use of the Tronair products in violations of cautions and warnings in any manual (including updates) or safety bulletins published or delivered by Tronair will immediately void any warranty, express or implied and Tronair disclaims any and all liability for injury (WITHOUT LIMITATION and including DEATH), loss or damage arising from or relating to such misuse.**

Parts List

When ordering replacement parts/kits, please specify model, serial number and color of your unit.

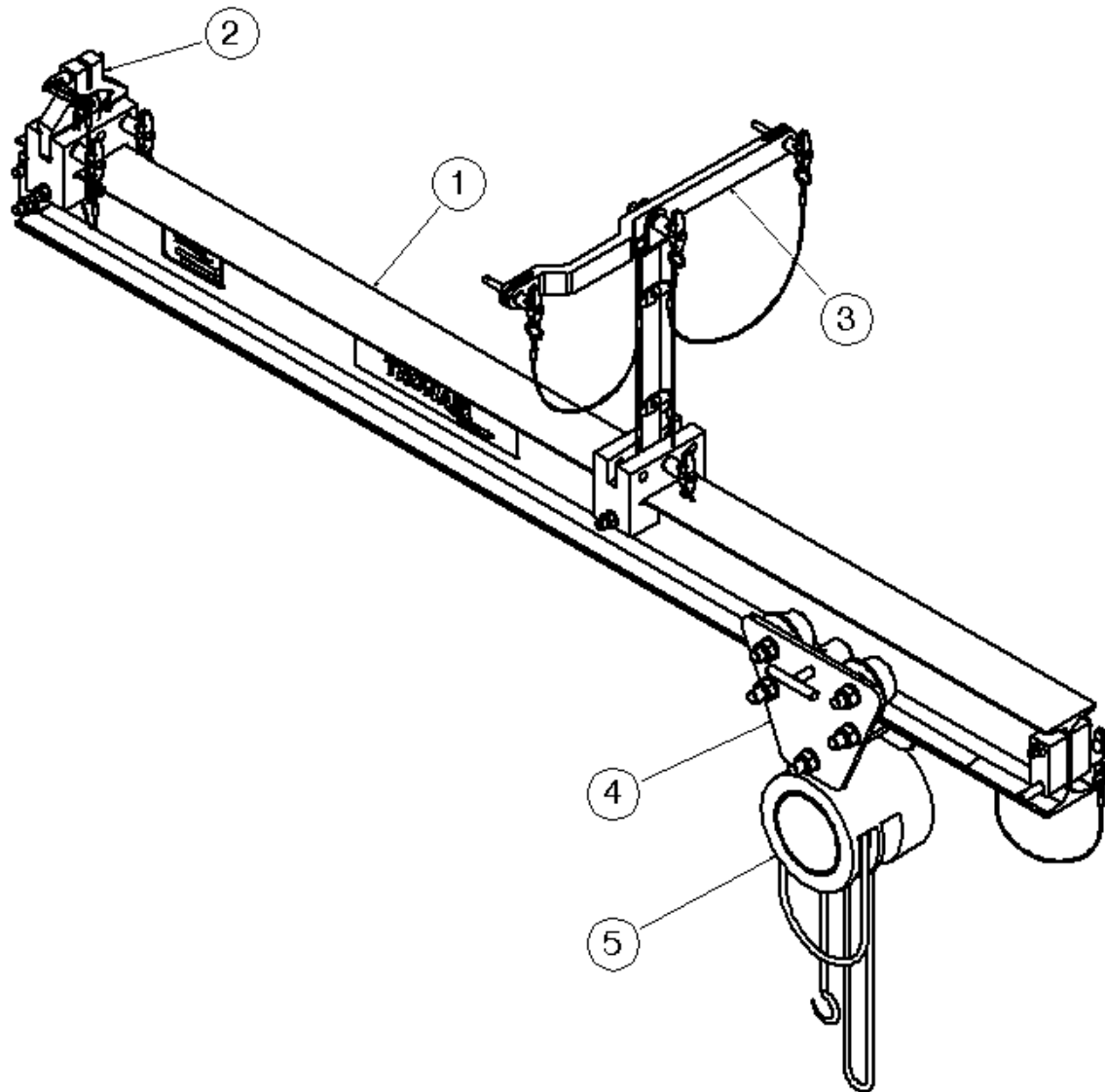

Item	Part Number	Description	Qty
1	Z-4292	Assembly, Fuselage Hoist Beam	1
2	Z-4294	Assembly, Aft Mount Strap	2
3	Z-9443	Assembly, Engine Strap	1
4	Z-4291	Assembly, Trolley	1
5	H-2247	Puller, 1/2 Ton Chain Hoist	1
Not Shown	W-1067	Assembly, Fuselage Hoist Box	1

Parts List

When ordering replacement parts/kits, please specify model, serial number and color of your unit.

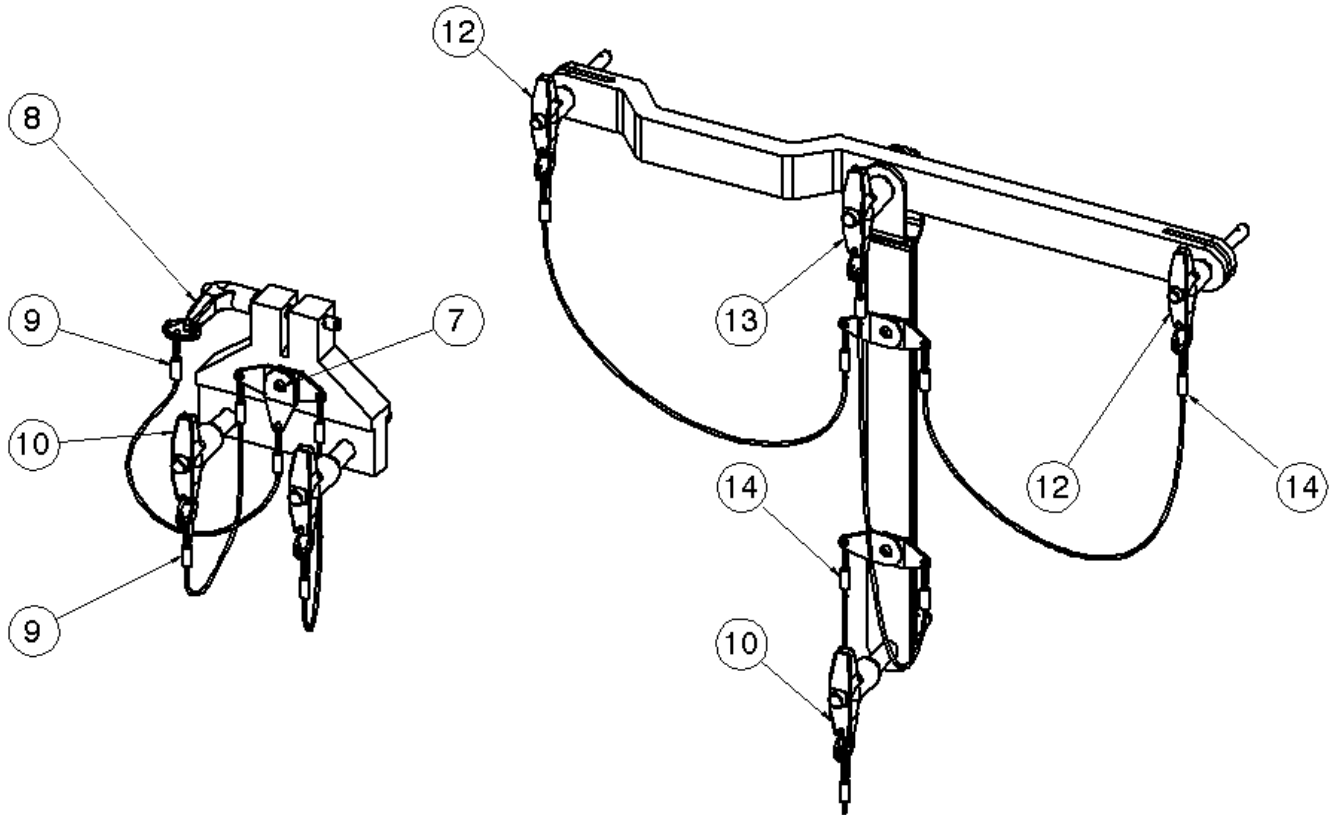

Item	Part Number	Description	Qty
	K-2376	Kit, Ball Lok-T Pin Replacement; consists of:	
7	G-1351-04	Rivet, Pop	1
8	G-1309-0415	Pin, ¼ x 1.5 Ball Lok-L	1
9	H-1026*07.0	Assembly, Lanyard	1
10	G-1310-0620	Pin, Ball Lok-T, ⅜" diameter x 2" long	1
12	G-1310-0415	Pin, ¼ x 1.5 Ball Lok-T	1
13	G-1310-0610	Pin, Ball Lok-T, ⅜" diameter x 1" Long	1
14	H-1026*12.0	Assembly, Lanyard	4

Parts List

When ordering replacement parts/kits, please specify model, serial number and color of your unit.

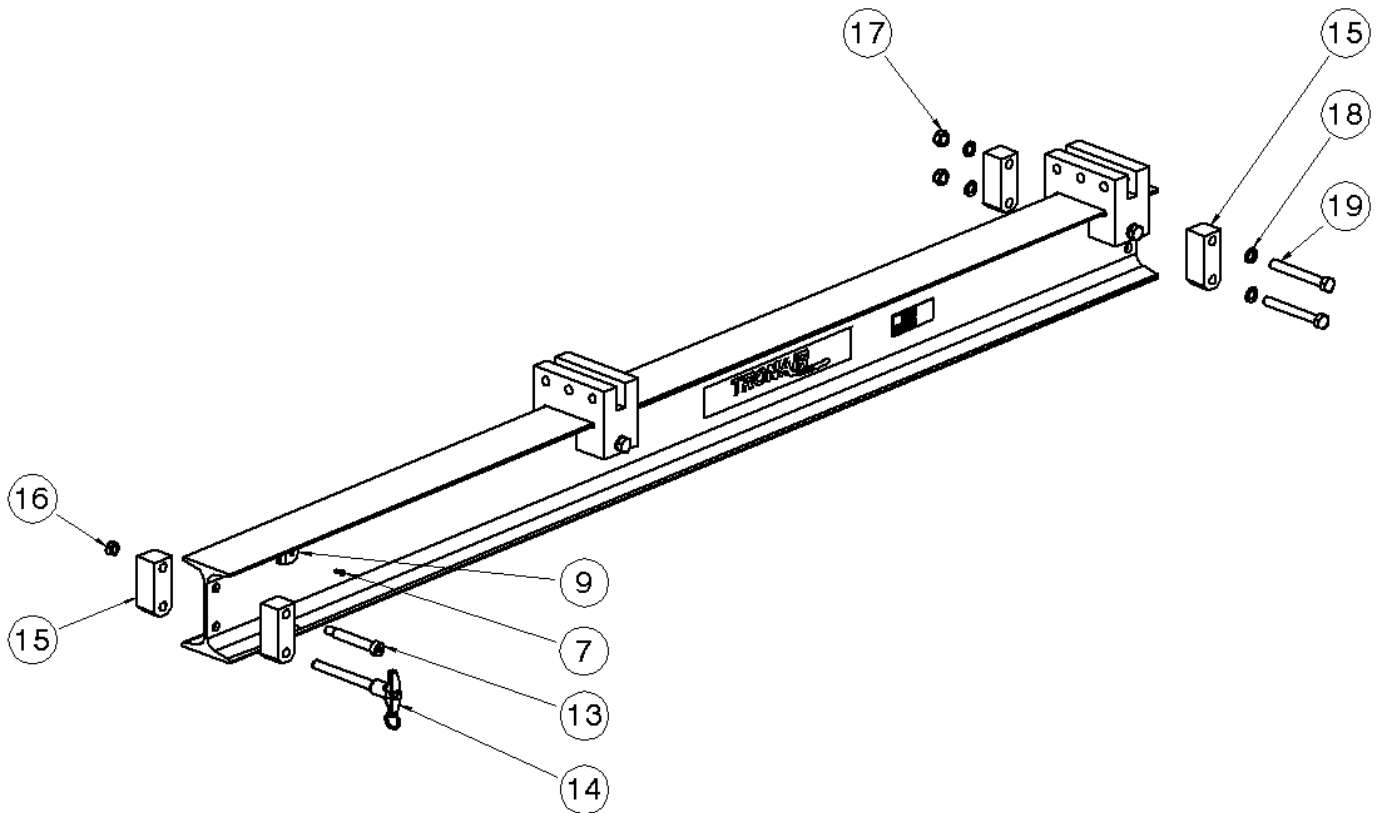

Item	Part Number	Description	Qty
13	G-1155-106222	Screw, Socket Head Shoulder, 3/8" diameter	1
15	J-6474	Block, Stop	2
16	G-1202-1060	Stopnut, 5/16-18 Elastic	1
	K-2296	Kit, Ball Lok-T Pin Replacement; consists of:	
7	G-1351-04	Rivet, Pop	1
9	H-1026*07.0	Assembly, Lanyard	1
14	G-1310-0630	Pin, Ball Lok-T, 3/8" diameter x 3" long	1
	K-5209	Kit, Stop Block Replacement; consists of:	
15	J-6474	Block, Stop	2
17	G-1202-1075	Stopnut, 3/8-24 Elastic	2
18	G-1255-07	Washer, 3/8 AN	4
19	G-1100-107530	Bolt, Hex Head, Grade 5, 3/8-24 x 3" long	2