



OPERATION & SERVICE MANUAL

**Model: 14-6836-0000
Main Landing Gear Sling
Global Express**



03/2023 – Rev. 01

**For Spare Parts, Operations & Service Manuals or Service Needs
Scan the QR code or visit [Tronair.com/aftermarket](https://tronair.com/aftermarket)**



REVISION	DATE	TEXT AFFECTED
OR	07/1996	Original release
01	03/2023	Major revision

TABLE OF CONTENTS

	<u>PAGE</u>
1.0 PRODUCT INFORMATION	4
1.1 DESCRIPTION.....	4
1.2 MODEL & SERIAL NUMBER.....	4
1.3 MANUFACTURER.....	4
1.4 SPECIFICATIONS	4
2.0 SAFETY INFORMATION.....	4
2.1 USAGE AND SAFETY INFORMATION	4
2.2 GENERAL	4
3.0 TRAINING	5
4.1 TRAINING REQUIREMENTS	5
3.2 TRAINING PROGRAM	5
3.3 OPERATOR TRAINING.....	5
4.0 OPERATION.....	5
4.1 ASSEMBLY.....	5
5.0 MAINTENANCE.....	6
5.1 INSPECTION	6
5.2 EVERY LIFT INSPECTION (performed visually by operator)	6
5.3 FREQUENT & PERIODIC INSPECTIONS (performed by designated personnel).....	6
5.4 LOAD TEST	6
6.0 PROVISION OF SPARES.....	6
6.1 SOURCE OF SPARE PARTS.....	6
6.2 RECOMMENDED SPARE PARTS LISTS	6
7.0 GUARANTEES/LIMITATION OF LIABILITY	7

This product can not be modified without the written approval of Tronair, Inc. Any modifications done without written approval voids all warranties and releases Tronair, Inc., its suppliers, distributors, employees, or financial institutions from any liability from consequences that may occur. Only Tronair OEM replacement parts shall be used.

1.0 PRODUCT INFORMATION

1.1 DESCRIPTION

This Tronair Main Landing Gear (MLG) Sling, 14-6836-0000, is designed to aid in the installation and removal of an aircraft's main landing gear.

1.2 MODEL & SERIAL NUMBER

Reference nameplate on unit

1.3 MANUFACTURER

TRONAIR, Inc.
1 Air Cargo Pkwy East
Swanton, Ohio 43558 USA

Telephone: (419) 866-6301 or 800-426-6301
Fax: (419) 867-0634
E-mail: sales@tronair.com
Website: www.tronair.com

1.4 SPECIFICATIONS

Maximum Capacity..... 1200 lbs. (544 kg)
Length..... 20.31 in (51.59 cm)
Width..... 17.07 in (43.36 cm)
Height..... 4 in (10.16 cm)
Weight..... 13 lbs (5.9 kg)

2.0 SAFETY INFORMATION

2.1 USAGE AND SAFETY INFORMATION

To insure safe operations please read the following statements and understand their meaning. Also refer to your equipment manufacturer's manual for other important safety information. This manual contains safety precautions which are explained below. Please read carefully.



WARNING!

Warning is used to indicate the presence of a hazard that can cause **severe personal injury, death, and/or substantial property damage** if the Warning Notice is ignored.



CAUTION!

Caution is used to indicate the presence of a hazard, which will or can cause **minor personal injury or property damage** if the Caution Notice is ignored.

2.2 GENERAL



WARNING!

Denote practices which if not carefully followed, could result in **SERIOUS** personal injury or death, and/or minor personal injury or damage to this equipment.

- NEVER exceed rated load or lift a load not intended for this sling.
- NEVER use sling if any damage or excessive wear is found.
- NEVER lift suspended loads over personnel.
- NEVER make any alterations or modifications to sling.
- ALWAYS stay clear of suspended loads.



CAUTION!

Ensure MLG is balanced on sling. If MLG is unbalanced, check that the orientation of sling is correct. In the event of an unbalanced condition, loss of control and/or damage may occur to the MLG along with injury to operator.

- NEVER use sling to lift personnel.
- NEVER leave suspended loads unattended.
- NEVER remove or obscure warning labels.
- DO NOT use sling until you have read and understood this manual.
- NEVER lift loads higher than necessary.

3.0 TRAINING**4.1 TRAINING REQUIREMENTS**

The employer of the operator is responsible for providing a training program sufficient for the safe operation of the unit.

3.2 TRAINING PROGRAM

The employer provided operator training program should cover safety procedures concerning use of the unit in and around the intended aircraft at the intended aircraft servicing location.

3.3 OPERATOR TRAINING

The operator training should provide the required training for safe operation of the unit.

NOTE: Maintenance and Trouble Shooting are to be performed by a skilled and trained technician.

4.0 OPERATION**CAUTION!**

Operator injury and/or component damage can result.

- Sling is only to be used to lift a main landing gear up to a maximum load of 1200 lbs.
- Keep feet and all body parts clear from underneath the sling during lifting operations.

4.1 ASSEMBLY

- Attach the two sides of the sling to the MLG's axle mount.
- Using a lifting device rated for the load, attached to the sling's hoist, raise the sling to position the for the purpose of installation, removal or maintenance required.

5.0 MAINTENANCE**5.1 INSPECTION**

SERVICE	INTERVAL	
Normal	Yearly	Inspect equipment at site of use. Operation with various weights within the rated load limit, or uniform loads less than 65 percent of rated load.
Heavy	Semi-Annual	Inspect equipment at site of use unless external conditions indicate that disassembly should be done to permit detailed inspection. Operation within the rated load limit that exceeds normal service.
Severe	Quarterly	Inspect equipment at site of use unless external conditions indicate that disassembly should be done to permit detailed inspection. Operation at normal or heavy service under abnormal operating conditions.
Special/ Infrequent	As recommended by a qualified person before the first such use and as directed by the qualified person for any subsequent uses	

5.2 EVERY LIFT INSPECTION

Performed visually by operator

- Missing parts (bolts, nuts, labels, etc)
- Operation of all hoist components
- Inspect sling components for any signs of material deformation, cracks, or excessive wear

5.3 FREQUENT & PERIODIC INSPECTIONS

Performed by designated personnel

- Visual (Monthly)
- Record (Semi-Annually)
- Loose bolts and fasteners
 - Loose bolts and fasteners
 - Cracked or excessively worn material or hardware components
 - Excessive wear at hoist points & bolts

5.4 LOAD TEST

This sling was proof tested. Test certification is included with documentation. The sling should be load tested annually. Use a fixed fixture and load cell (due to sling hoist not being centered on sling's bar which may result in an unbalanced load condition). Load test to at least 125% of rated capacity unless otherwise recommended by the manufacturer. Test weights shall be accurate to within -5 percent, +0 percent of stipulated values.

Rated load: 1200 lbs.

TEST PROCEDURE:

1. Load test sling to 125% of rated load
2. Hold for one (1) minute.
3. Remove the sling from the test weight and inspect the entire sling for broken welds, elongated holes, or any other signs of failure.)

6.0 PROVISION OF SPARES**6.1 SOURCE OF SPARE PARTS**

Spare parts may be obtained from the manufacturer:

TRONAIR, Inc.

1 Air Cargo Pkwy East

Swanton, Ohio 43558 USA

Telephone: (419) 866-6301 or 800-426-6301

Fax: (419) 867-0634

E-mail: sales@tronair.com

Website: www.tronair.com

For Spare Parts, Operations & Service Manuals or Service Needs:

Scan the QR code or visit Tronair.com/aftermarket

6.2 RECOMMENDED SPARE PARTS LISTS

Reference the following page(s) for Replacement Parts and Kits available.



7.0 GUARANTEES/LIMITATION OF LIABILITY

Tronair products are warranted to be free of manufacturing or material defects for a period of one year after shipment to the original customer. This is solely limited to the repair or replacement of defective components. This warranty does not cover the following items:

- a) Parts required for normal maintenance
- b) Parts covered by a component manufacturers warranty
- c) Replacement parts have a 90-day warranty from date of shipment

If you have a problem that may require service, contact Tronair immediately. Do not attempt to repair or disassemble a product without first contacting Tronair, any action may affect warranty coverage. When you contact Tronair be prepared to provide the following information:

- a) Product Model Number
- b) Product Serial Number
- c) Description of the problem

If warranty coverage is approved, either replacement parts will be sent or the product will have to be returned to Tronair for repairs. If the product is to be returned, a Return Material Authorization (RMA) number will be issued for reference purposes on any shipping documents. Failure to obtain a RMA in advance of returning an item will result in a service fee. A decision on the extent of warranty coverage on returned products is reserved pending inspection at Tronair. Any shipments to Tronair must be shipped freight prepaid. Freight costs on shipments to customers will be paid by Tronair on any warranty claims only. Any unauthorized modification of the Tronair products or use of the Tronair products in violation of cautions and warnings in any manual (including updates) or safety bulletins published or delivered by Tronair will immediately void any warranty, express or implied.

The obligations of Tronair expressly stated herein are in lieu of all other warranties or conditions expressed or implied. **Any unauthorized modification of the Tronair products or use of the Tronair products in violations of cautions and warnings in any manual (including updates) or safety bulletins published or delivered by Tronair will immediately void any warranty, express or implied and Tronair disclaims any and all liability for injury (WITHOUT LIMITATION and including DEATH), loss or damage arising from or relating to such misuse.**

Parts List

When ordering Replacement Parts/Kits, please specify Model, Color and Serial Number of your Unit

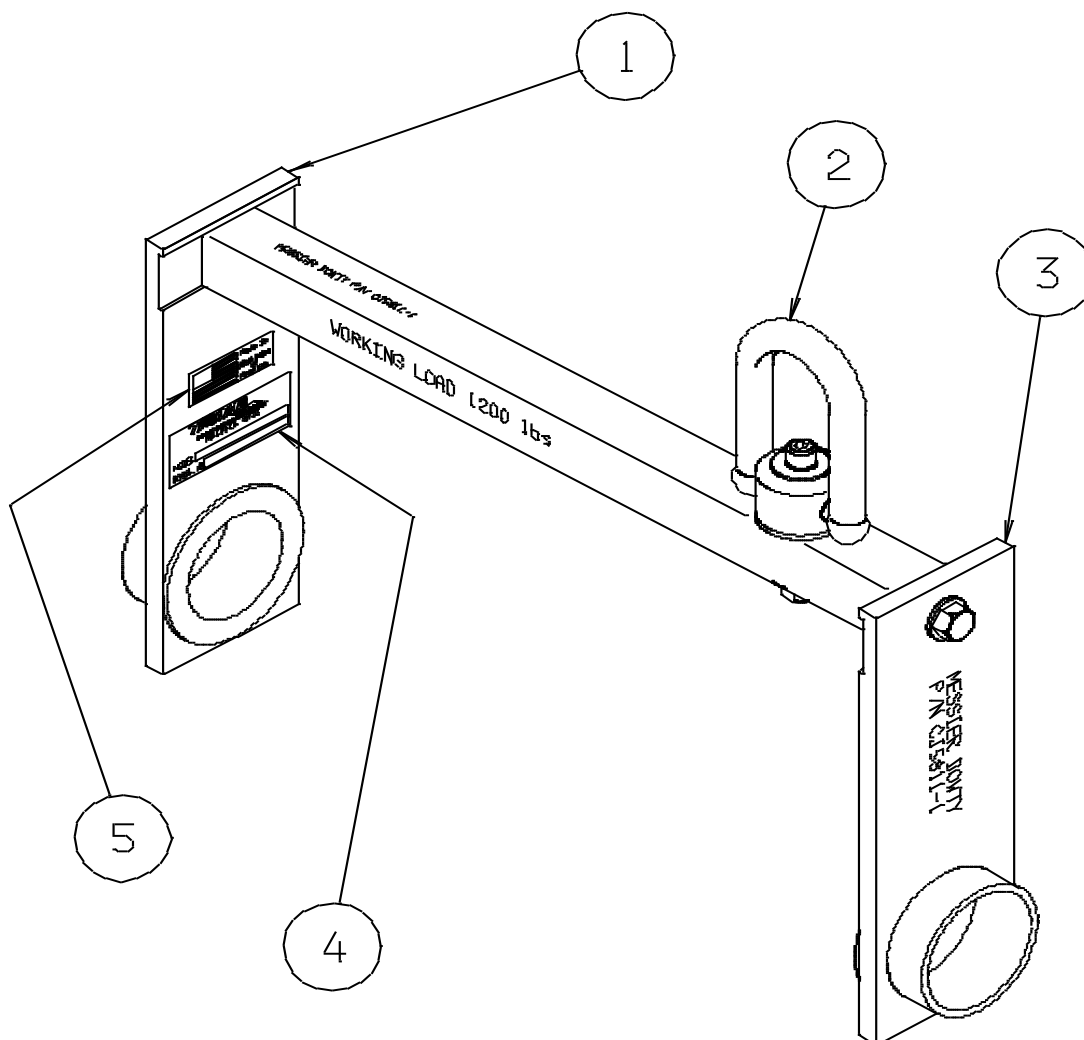

Item	Part Number	Description	Qty
	K-2629	Kit, MLG Left Side; consists of:	
1		MLG Sling Left Side Assembly	1
4		Serial Number Label, required mounting hardware	1
5		Made in USA Label	1
	K-2630	Kit, Hoist Ring; consists of:	
2		Heavy Duty Hoist Ring	1
		Required Mounting Hardware	1
	K-2631	Kit, MLG Right Side; consists of:	
3		MLG Sling Right Side Assembly	1
		Required Mounting Hardware	1